



### 611/3 Carlton Street Chippendale NSW

1  1 

Perfectly located just outside Sydney CBD is this chic apartment ideal for young professionals or 1st home buyers working in the city or North Sydney. The apartment is just on top of Central Park mall which has an abundance of stores including Woolies, Priceline, an Asian grocery, fashion outlets, banks and a foodcourt. It is also located next to trendy restaurants, bars and cafes on Kensington Street! There are buses on your doorstep and car sharing facilities in the car park too!

Other points of interest that are in walking distance are:

1. Broadway shopping centre,
2. Glebe Point road
3. Newtown

[For full version visit the website](#)

**Type** : Apartment

**View** : <https://www.recoproperty.com.au/7705483>

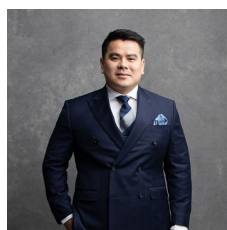

**Junianto Junianto**  
02 8357 3377



**Anna Le**  
02 8357 3377

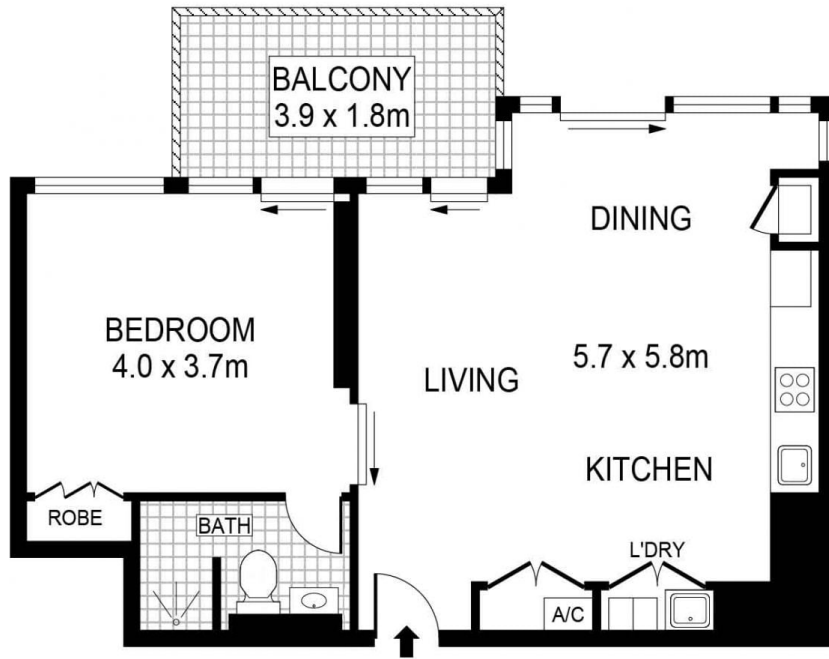

OP-01



LEVEL SIX



This floor plan is for marketing purposes and is to be used as a guide only. All efforts have been made to ensure its accuracy although interested parties are urged to rely on their own enquiries.