



167 Bridge Road GLEBE NSW

4  2 

Rarely does an impressive home of such classic style and grand proportions become available for purchase. This beautifully presented free-standing Victorian residence has recently undergone a stylish renovation which thoughtfully combines the elegance and grace of a bygone era with modern family living.

Enter through a leaded side-lit front door to a generous hall which opens onto the traditional formal lounge/ dining rooms featuring rich cedar joinery, polished timber floors, lofty ornate ceilings and four original fire places. A cedar staircase spans the three levels. Accommodation consists of four double bedrooms, master with en-suite, three have balconies, some with built-in robes. The fourth bedroom is attic style and occupies the entire third level.

Type : House
Price : \$ 1,650,000
Land Size : 377 sqm
View : <https://www.recoproperty.com.au/8065427>



Real Estate EST. 1980

Garry White Real Estate
02 9660 1044

[For full version visit the website](https://www.recoproperty.com.au)

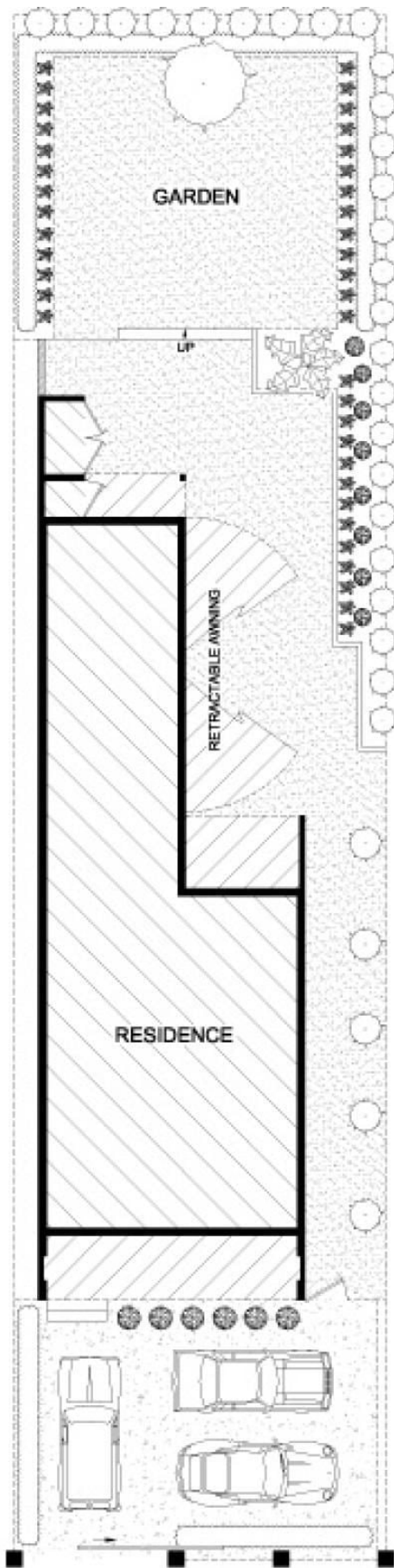

167 BRIDGE ROAD

GLEBE

PLANS SHOWN ARE ONLY INDICATIVE OF LAYOUT.
DIMENSIONS ARE APPROXIMATE

0 1 5
SCALE BAR in metres



METRO FLOORPLANS
0418 223 433