



1007/34 Wentworth Street GLEBE NSW

Recently refurbished, this studio apartment enjoys a striking 10th floor, north facing position.

Fresh kitchen and neat bathroom

North facing balcony with stunning city vistas

Carpeted throughout, currently leased for \$175 per week.

MUST SELL

Quarterly Outgoings- Strata: \$398.00 Water: \$114.80
Council: \$160.00

1 

Type : Studio

View : <https://www.recoproperty.com.au/8065433>



Real Estate EST. 1980

Garry White Real Estate
02 9660 1044

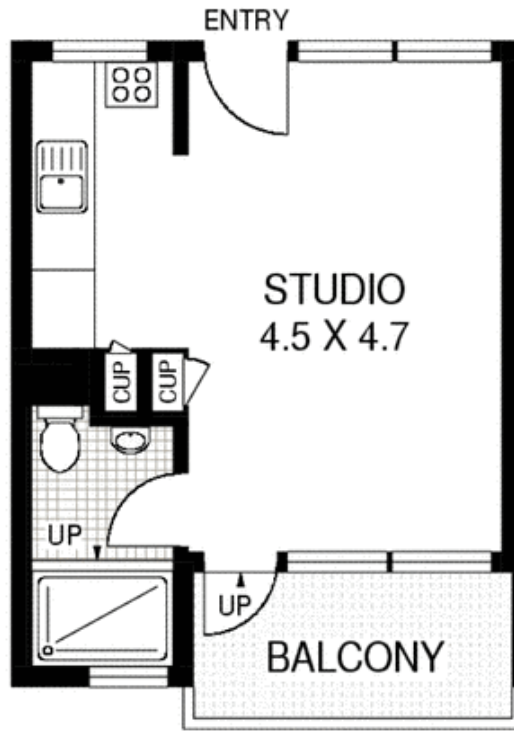

LEVEL TEN



APPROX : GROSS INTERNAL AREA : 22 SQM

1007/34 WENTWORTH STREET

GLEBE

Floor Plan Disclaimer: Mind the Gap (mtg) floor plans / site plans are intended as a guide only. No representations or warranties of any nature whatsoever are given or intended and any person using this information should always rely on their own enquiries, independent measuring services - 1300 133 145 - photography, floor plans, virtual tours, video tours, copy writing project marketing - www.mindthegap.com.au