



**27 Oxford Road STRATHFIELD NSW**

4  2  2 

Beyond the gracious Federation facade of this beautifully presented home lies an unexpectedly large floorplan that is stylishly renovated to maximise space, natural light and easy in/outdoor living.

- A selection of formal & casual living spaces
- Spacious upper level retreat with wide terrace
- N facing, outdoor entertaining plus lawn with gardens
- Deluxe CaesarStone kitchen, garage & carport
- Superb setting a stroll to schools, trains & parklands

**Type** : House  
**Land Size** : 807 sqm  
**View** : <https://www.recoproperty.com.au/8065479>



Real Estate EST. 1980

**Garry White Real Estate**  
**02 9660 1044**

**LOWER LEVEL**



**ENTRY LEVEL**

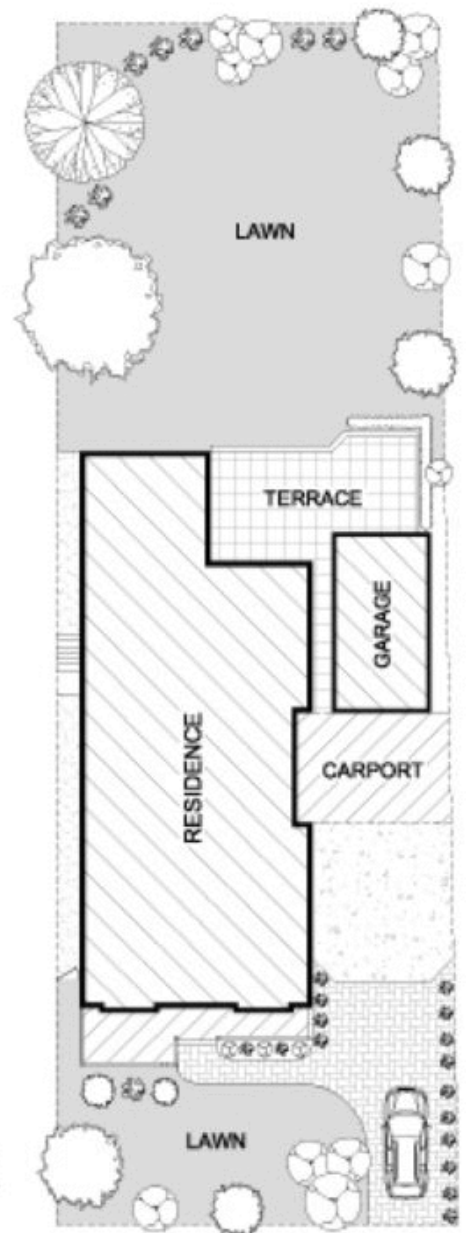

**SITE PLAN**



27 OXFORD ROAD

STRATHFIELD

PLANS SHOWN ARE ONLY INDICATIVE OF LAYOUT. DIMENSIONS ARE APPROXIMATE.



METRO FLOORPLANS  
0418 223 433