



**1/2 Piper Street ANNANDALE NSW**

2  1  1 

This property is being offered for the first time in more than 30 years and offers a fantastic opportunity to secure an affordable entry into the highly prized Annandale north precinct. This two bedroom townhouse enjoys a premium location, perfect orientation and enormous potential

**Type** : Townhouse  
**Building Size** : 74 sqm  
**View** : <https://www.recoproperty.com.au/8065491>

- \*Open light filled interiors with timber floors
- \*2 comfortable bedrooms with upstairs bathroom
- \*Front and rear entrances and car parking for one
- \*Small Strata Plan od 8 lots with strong future potential

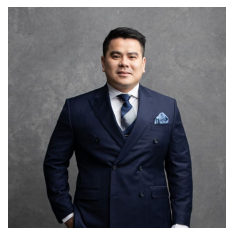

**Junianto Lianto**  
**02 8357 3377**

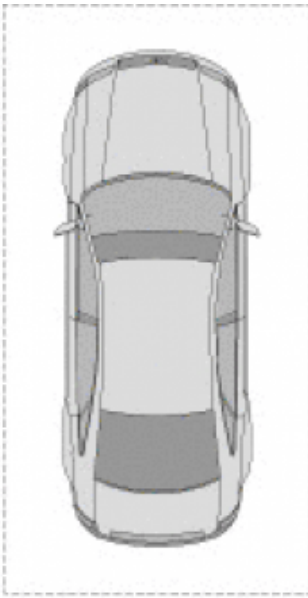

**CARSPACE**  
(On Title)



**LEVEL 2**

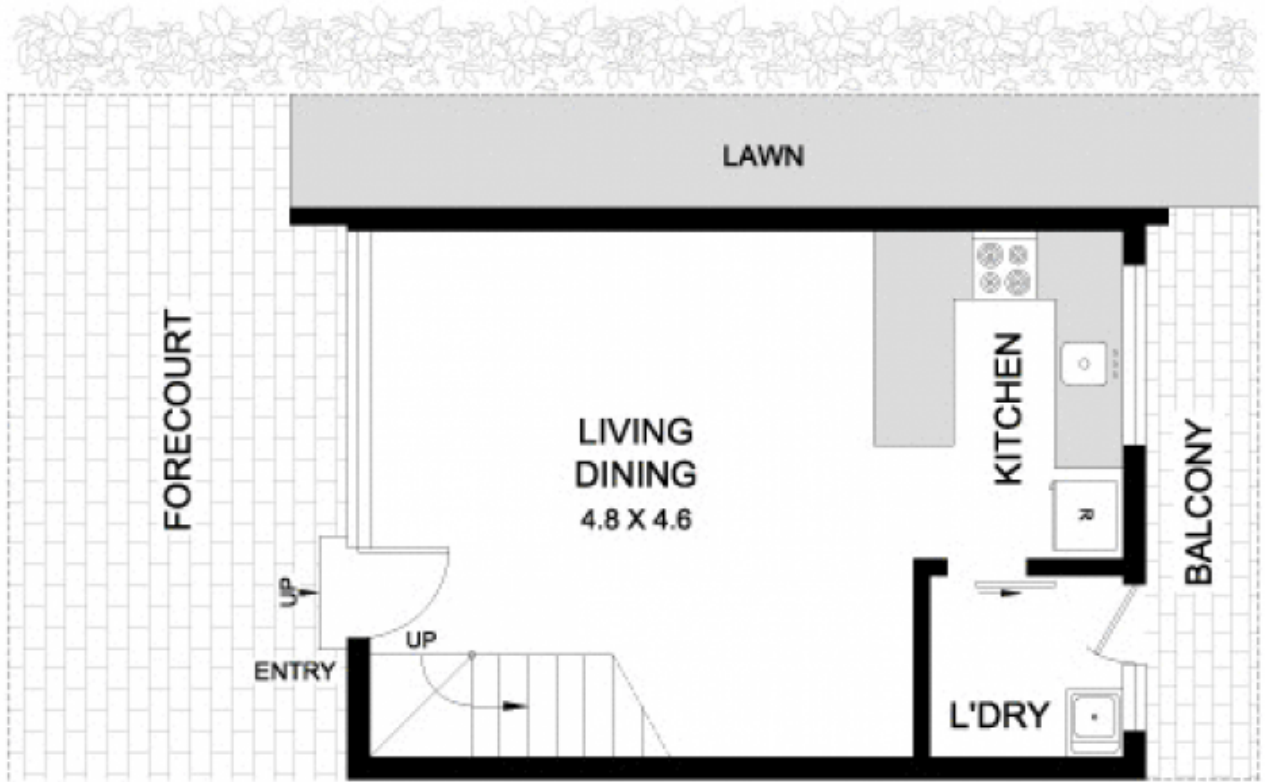

**LEVEL 1**

**NOTE: EXTERNAL AREAS NOT ON TITLE**



**1/2 PIPER STREET (EAST)**

**ANNANDALE**

PLANS SHOWN ARE ONLY INDICATIVE OF LAYOUT.  
DIMENSIONS ARE APPROXIMATE



SCALE BAR in metres



**METRO FLOORPLANS**  
0418 223 433



**Garry White**

**FIRST NATIONAL REAL ESTATE**