



14/141 Trafalgar Street ANNANDALE NSW

2  2  1 

Displaying a designer feel that takes full advantage of the space, this stylish townhouse is highly private, exceptionally secure and cleverly designed with an array of smart modern finishes. Placed to the rear of a boutique security complex, it is located within footsteps to village shops, light-rail and cafes.

Type : Townhouse
Building Size : 168 sqm
View : <https://www.recoproperty.com.au/8065505>

- Bright open living with polished parquet flooring
- Sunlit courtyard & outdoor entertaining space
- Lock up garage plus storage with internal access
- Upstairs bedrooms include main with walk-in robe
- Well-appointed granite and s/steel gas kitchen
- Full bathroom, internal laundry and guest wc

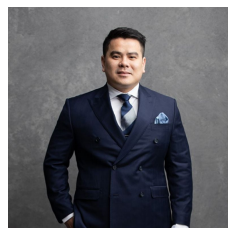

Junianto Lianto
02 8357 3377

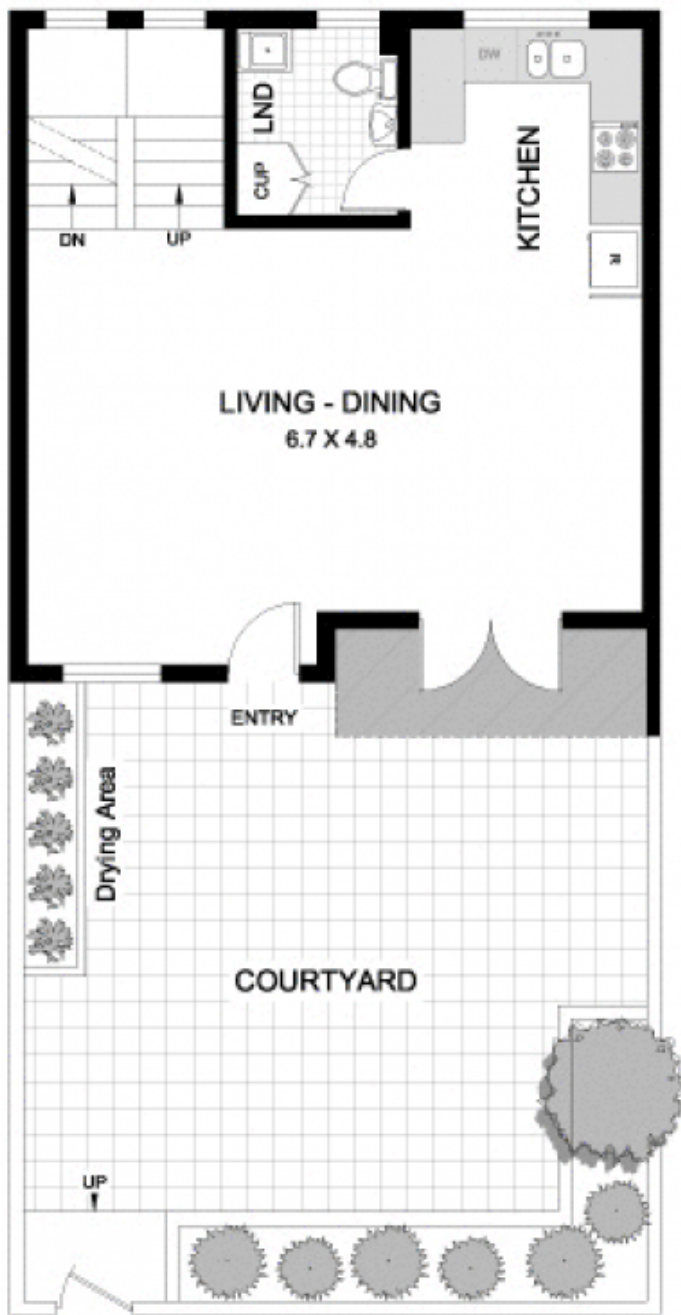

ENTRY LEVEL



UPPER LEVEL

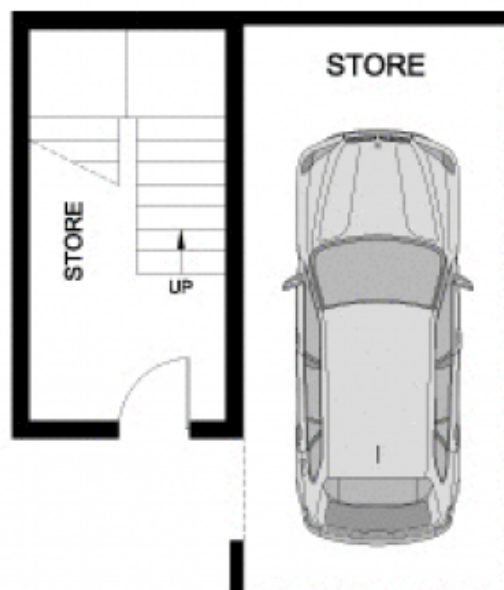

BASEMENT SECURITY



14/141 TRAFALGAR STREET ANANDDALE



PLANS SHOWN ARE ONLY INDICATIVE OF LAYOUT.
DIMENSIONS ARE APPROXIMATE



METRO FLOORPLANS
0418 223 433



Garry White

FIRST NATIONAL REAL ESTATE