

### 106 Newton Road STRATHFIELD NSW

3  1  1 

First time offered, this original cottage is located in one of Strathfield's most sought after addresses and amongst some of the suburbs finest homes. The property is on a wide, level, generously proportioned block adjoining parkland. It presents purchasers with a fantastic and affordable opportunity to build their dream home in a wonderful location.

\*Large, level, 893sqm block with a 16.76m frontage

\*Solid three bedroom cottage with garage

\*Peaceful tree-lined street with easy access to transport

\*Centrally located, close to numerous elite and popular schools

**Type** : House

**Land Size** : 893 sqm

**View** : <https://www.recoproperty.com.au/8065538>

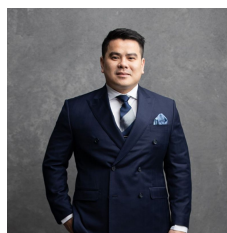

**Junianto Lianto**  
02 8357 3377

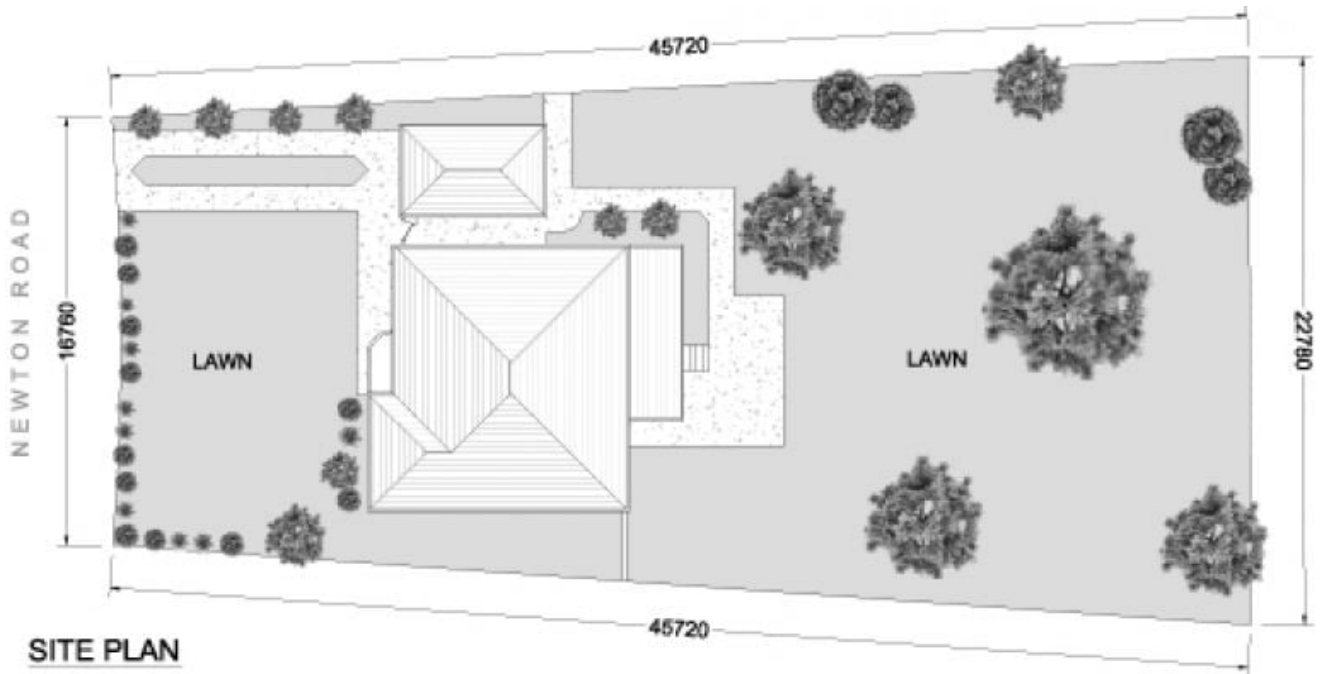

**SITE PLAN**  
(at reduced scale)

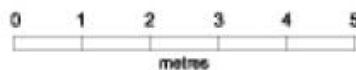
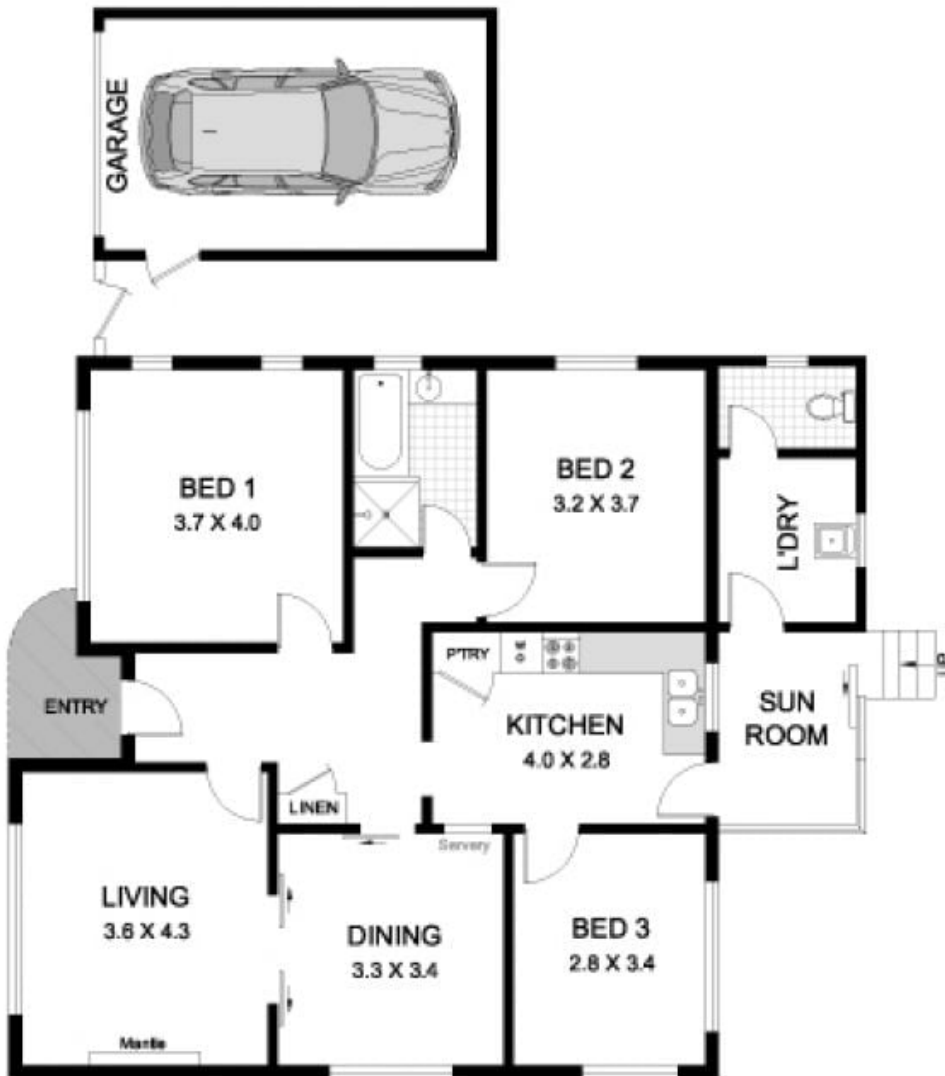

This plan is for illustrative purposes only and dimensions are approximate. It does not constitute part of any legal document or commercial contract for the sale or lease of this property.



**METRO FLOORPLANS**  
0416 223 433

**106 NEWTON ROAD**  
**STRATHFIELD**